

NEW!



HIGHLIGHTS :

A) Tapping Chucks

- BPT tension and compression type tap chuck assembly having **minimum of ± 7.5 to maximum ± 25 mm tension and compression range** which is around 2 to 3 times comparatively with respect to competitor tapping system.
- Because the above BPT tapping system can produce higher tapping depth without breaking the tap, this results in the **increase in the tap life in critical deep hole tapping operations.**
- High quality imported spare parts applied giving **best in class tension and compression system.**
- **Smoothest** movement of tapping and compression system available in market.

B) Tap Adapters

- Three nos. of high quality steel balls ensure perfect location of tap on tap shank, which ensures **superior rotation of the taps.**
- Safe drive clutch type tap adapters consist of imported quality tested disc spring, **which ensures correct torque slippages to avoid breaking of tap during operation.**
- Combination of BPT Tap chuck and Tap adapters is a perfect solution to customers **to increase the tap life and reduces setup time.**

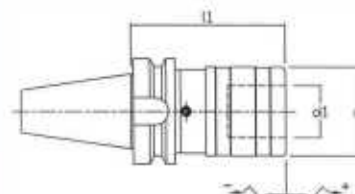

Tap Chuck - Tension & Compression

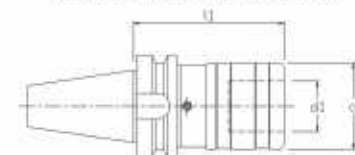

Tap Chuck - Solid Type

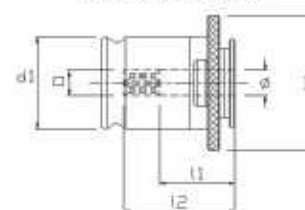

Quick Change Tap Adaptor
without overload clutch

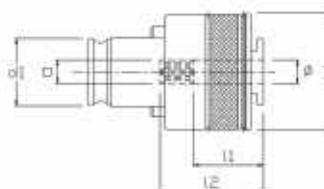

Quick Change Tap Adaptor
with overload clutch

Tap Chuck - Tension & Compression

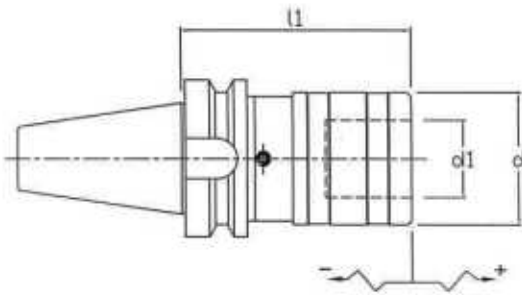

Available in Standard ISO & HSK Shanks :
BT30, BT40, BT50, DV30, DV40, DV50, HSK50, HSK63, HSK100.

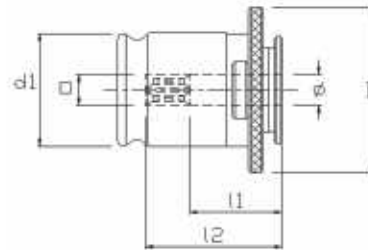

Quick Change Tap Adaptor
without overload clutch

Rc1 (M1 to M14)
RC2 (M5 to M24)
RC3 (M14 to M36)

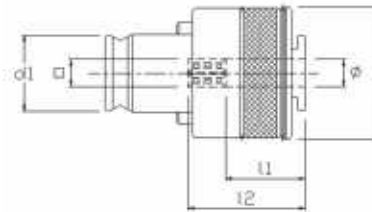

Quick Change Tap Adaptor
with overload clutch

Rs1 (M1 to M14)
RS2 (M5 to M24)
RS3 (M14 to M36)

**VISUAL
PLUS**

Tap Chuck - Solid Type

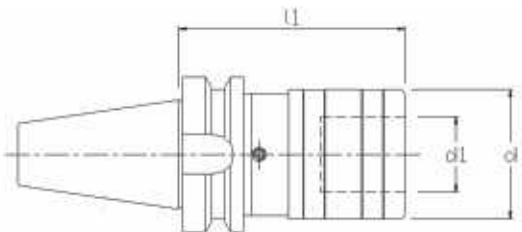

Available in Standard ISO & HSK Shanks :
BT30, BT40, BT50, DV30, DV40, DV50, HSK50, HSK63, HSK100.

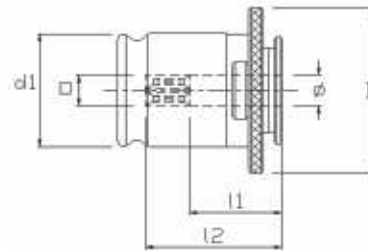

Quick Change Tap Adaptor
without overload clutch

Rc1 (M1 to M14)
RC2 (M5 to M24)
RC3 (M14 to M36)

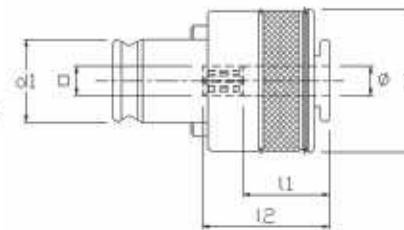

Quick Change Tap Adaptor
with overload clutch

Rs1 (M1 to M14)
RS2 (M5 to M24)
RS3 (M14 to M36)

For details refer BPT Catalogue No - BPT/TCA/08/2017



BIRLA PRECISION TECHNOLOGIES LIMITED

REGISTERED OFFICE : 23, Birla Mansion No. 2, 1st Floor, D. D. Sathe Marg,
Prarthana Samaj, Mumbai 400 004 | Ph No. 022-23867498
website: www.birlaprecision.com



• BRANCHES •

Mumbai : (022) 66168400
Pune : (020) 27123477
Bangalore : (080) 22128347
Chennai : (044) 25342636

Hyderabad : (040) 27713177
Gujarat : (079) 22123277
MP (Indore) : 9993592691
Ludhiana : (0161) 2722535

Delhi : (011) 43575500, 23278531, 23276809
Uttarakhand : +91 9012462818
Kolkata : (033) 22485191
Kanpur : +91 9935112276

CUSTOMER CARE

For Export Enquiries : (022) 66168400

Ph: (0240) 2554300 | Email: info@birlaprecision.com